

Aug 5, 2009



# LAMC 2007 MASTER PLAN EIR ADDENDUM



## CEQA Process

### Environmental Impact Reports

### EIR Addendum Process

### 2007 Master Plan

### Proposed 2007 Master Plan Revisions

### Comparison of 2007 EIR and Addendum Findings

### Conclusion of EIR Addendum



# CEQA PROCESS

Aug 5, 2009

## ENVIRONMENTAL IMPACT REPORTS

- LACCD prepared EIR for the 2007 Master Plan (the “Project”) to identify, avoid and minimize significant environmental impacts
- CEQA anticipates changes in Projects
  - **Substantial Changes:** Prepare Supplemental EIR and recirculate SEIR to public agencies and public for review and comment
  - **Minor Revisions:** Prepare Addendum to original EIR. No recirculation is required

## EIR ADDENDUM PROCESS

- Document that Master Plan Revisions are minor in nature
- Document that substantial changes in environmental impacts would not occur





**2007 Master Plan – Phase 2**  
**(BOT adopted March 2007)**



# Proposed 2007 Master Plan Revisions

Aug 5, 2009



➤ Improve Master Plan design and constructability of West Campus

➤ Move Building 5 (Main Campus) and combine it with Building 6 on the East Campus.



➤ Eliminate the proposed extension of Eldridge Avenue through the East Campus to Maclay Avenue.

- To maintain traffic flow, improve the existing Harding Street connection

➤ Eliminate Underground Parking Structure on the East Campus

- Replace with Surface Parking Lot, solar panels, wind energy turbines

➤ Eliminate second parking structure on the Main Campus

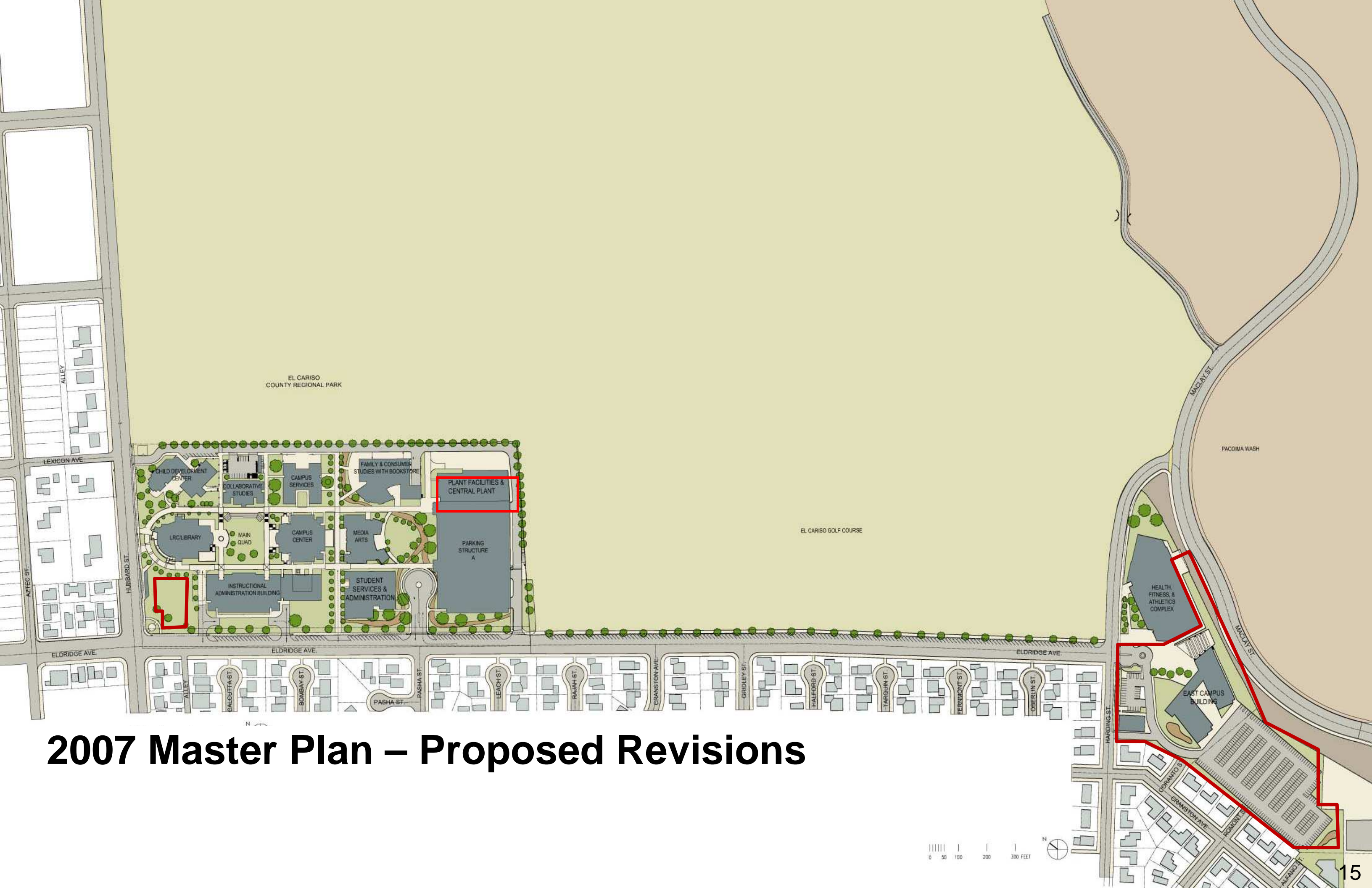

# 2007 Master Plan – Proposed Revisions







# 2007 EIR vs. EIR ADDENDUM

Aug 5, 2009



ENVIRONMENTAL RESOURCE	2007 EIR	EIR ADDENDUM
<b>Aesthetics</b>	<b>Significant</b>	<b>No New or Increased Impact</b>
Agricultural Resources	NI	No New or Increased Impact
<b>Air Quality (Construction + Automobiles)</b>	<b>Significant</b>	<b>No New or Increased Impact</b>
Biological Resources	LTS	No New or Increased Impact
Cultural Resources	LTS	No New or Increased Impact
Geology and Soils	LTS	No New or Increased Impact
Hazards & Hazardous Materials	LTS	No New or Increased Impact
Hydrology and Water Quality	LTS	No New or Increased Impact
Land Use and Planning	LTS	No New or Increased Impact
Mineral Resources	NI	No New or Increased Impact
<b>Noise (Temporary Construction)</b>	<b>Significant</b>	<b>No New or Increased Impact</b>
Population and Housing	LTS	No New or Increased Impact
Public Services	LTS	No New or Increased Impact
Recreation	LTS	No New or Increased Impact
<b>Transportation/Traffic</b>	<b>Significant</b>	<b>No New or Increased Impact</b>
Utilities and Service Systems	LTS	No New or Increased Impact



# COMPARISON OF VISUAL IMPACT

Aug 5, 2009

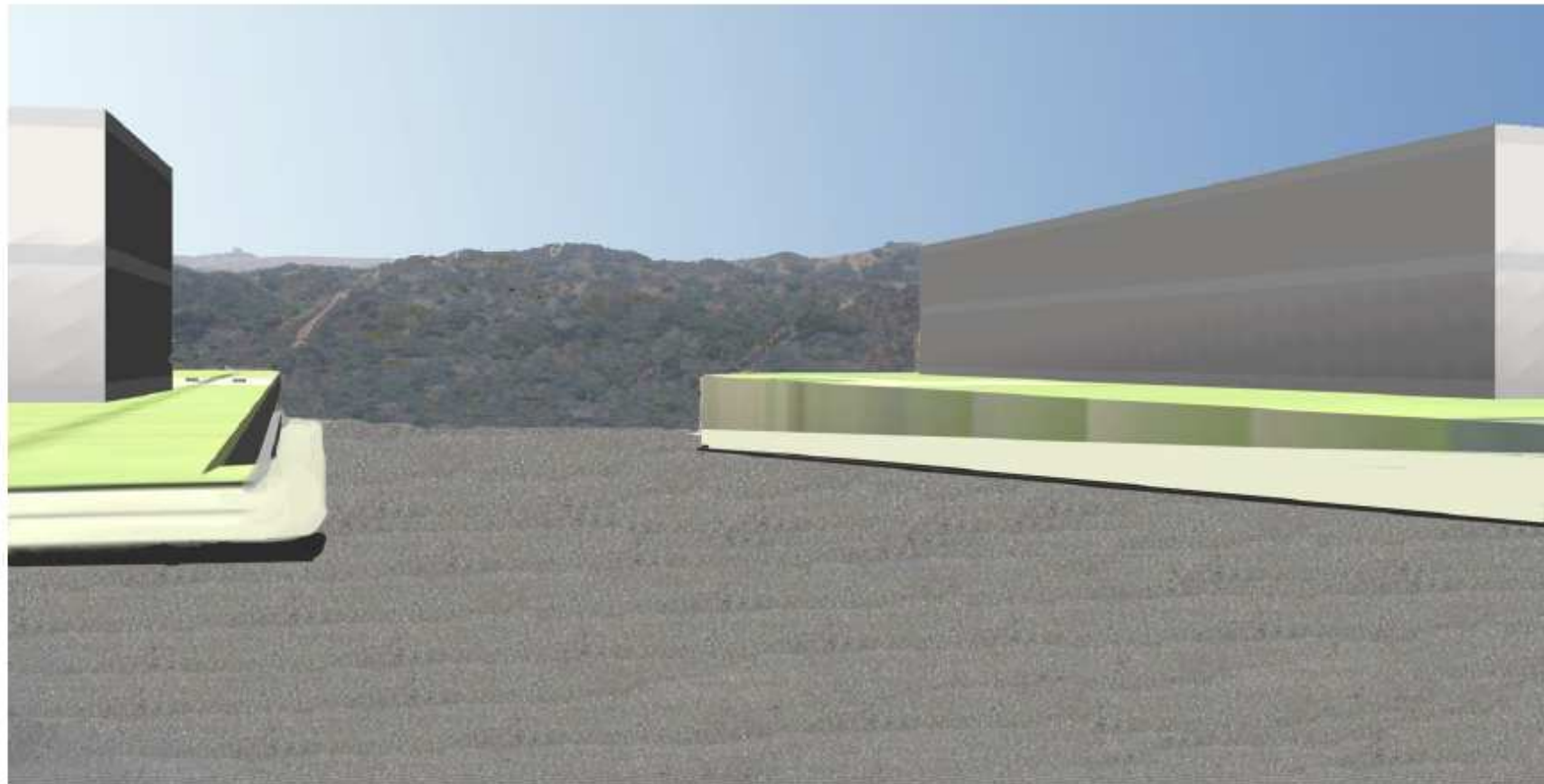

2007 MASTER PLAN



PROPOSED REVISIONS



# EIR ADDENDUM CONCLUSIONS

Aug 5, 2009

## EIR ADDENDUM CONCLUSIONS



- Revisions to the 2007 Master Plan are Minor in Nature
- No New Environmental Impacts or Increase in Severity of Impacts
- Conditions Requiring Preparation of a Supplemental EIR do not exist
- Approval of EIR Addendum may be used to Support Approval of Minor Revisions to the 2007 Master Plan

